

Tilt&Turn hardware – Basic security

Parts list

Application range

Sash Rebate Width (SRW) 290 – 1600 mm⁽¹⁾
 Sash Rebate Height (SRH)..... 280 – 2400 mm
 Sash weight max. 100 kg

1 T&T espagnolette, fixed handle height, backset 15 mm

SRH/mm	Handle height/mm	Espagnolette length/mm	Material no.
280 – 360 ⁽³⁾	120	370	284 314 ⁽²⁾
361 – 480 ⁽⁴⁾			
481 – 600	170	490	259 830
601 – 800	263	690	259 831
801 – 1000	413	890	259 834
1001 – 1200	513	1090	1 E 259 838
1201 – 1400	563	1290	1 E 259 840
1401 – 1600	563	1490	1 E 259 842
1601 – 1800	563	1690	2 E 259 846
1601 – 1800	1000	1690	2 E 259 847
1801 – 2000	1000	1890	2 E 259 849
2001 – 2200	1000	2090	2 E 259 851
2201 – 2400	1000	2290	2 E 259 854

2 T&T espagnolette, centred/variable handle height, backset 15 mm

SRH/mm	Handle height/mm	Espagnolette length/mm	Material no.
310 – 450 ⁽³⁾	155 – 225	430	259 717 ⁽²⁾
451 – 620 ⁽⁴⁾	225 – 310	400	259 718 ⁽²⁾
621 – 800	311 – 400	580	1 E 259 719
801 – 1200	401 – 600	980	1 E 259 720
1201 – 1600	601 – 800	1380	2 E 259 721
1601 – 2000	801 – 1000	1780	2 E 259 762
2001 – 2400	1001 – 1200	2180	4 E 259 763

3 Bullet catch cam **256 020**

4 Corner drive not dep. 1 E **260 275** Corner drive 1 P **260 277**

5 T&T corner drive 1 P **260 290**

6 Special corner drive not dep. 1 E **260 280** (SRH < 360 mm) Special corner drive 1 P **260 282** (SRH < 360 mm)

7 Stay guide

SRW/mm	Description/length	Material no.
290 – 410	150 / 300	260 201 ⁽⁵⁾
411 – 600	250 / 490	256 024
601 – 800	350 / 690	260 204
801 – 1000	500 / 890	260 205
1001 – 1200	500 / 1090	260 209
1201 – 1400 ⁽¹⁾	500 / 1290	1 E 260 215

8 Additional scissor stay (from SRW 1400 mm) **255 237**

9 Stay arm K, system 12/18-9

SRW/mm	Size	Material no.
290 – 410	150 ⁽⁶⁾	L 258 048 R 258 049
411 – 600	250	L 258 050 R 258 051
601 – 800	350	L 258 052 R 258 053
801 – 1400	500	L 258 037 R 258 038

9a Stay arm K, system 12/18-13

SRW/mm	Size	Material no.
290 – 410	150 ⁽⁶⁾	L 349 687 R 349 688
411 – 600	250	L 349 689 R 349 690
601 – 800	350	L 349 691 R 349 692
801 – 1400	500	L 349 693 R 349 694

9b Stay arm K, system 12/20-9

SRW/mm	Size	Material no.
290 – 410	150 ⁽⁶⁾	L 258 054 R 258 055
411 – 600	250	L 258 056 R 258 057
601 – 800	350	L 258 058 R 258 059
801 – 1400	500	L 258 039 R 258 041

9c Stay arm K, system 12/20-13

SRW/mm	Size	Material no.
290 – 410	150 ⁽⁶⁾	L 258 060 R 258 061
411 – 600	250	L 258 062 R 258 063
601 – 800	350	L 258 064 R 258 065
801 – 1400	500	L 258 042 R 258 043

10 Stay bearing K3/100 **230 177** Stay bearing K6/100 **230 178**

10a Stay-bearing pin **227 354**

11 Stay corner drive 1 P **260 286**

12 Multipart centre lock, horizontal and vertical

SRW/mm	SRH/mm	Size	Material no.
1101 – 1600	1101 – 1800	600	1 E 255 281
	1801 – 2400	600CON	1 E 255 282
		600	1 E 255 281

13 Rebate corner hinge NT Alu 12/18-9 L **616 324** R **616 366**

Rebate corner hinge NT Alu 12/18-13 L **616 367** R **616 368**

Rebate corner hinge NT Alu 12/20-9 L **616 369** R **616 370**

Rebate corner hinge NT Alu 12/20-13 L **616 371** R **616 372**

14 Rebate corner hinge extension **624 462**

15 Pivot rest K3/100 **258 590** Pivot rest K6/100 **258 592**

16 Lifting mishandling device, sash component **260 538**

Profile-related frame components: refer to the table on page 28-29

17 Lifting mishandling device, frame component

18 Horizontal Tilt&Turn striker

19 Striker

20 Bullet catch

21 Packers for tilt-stay

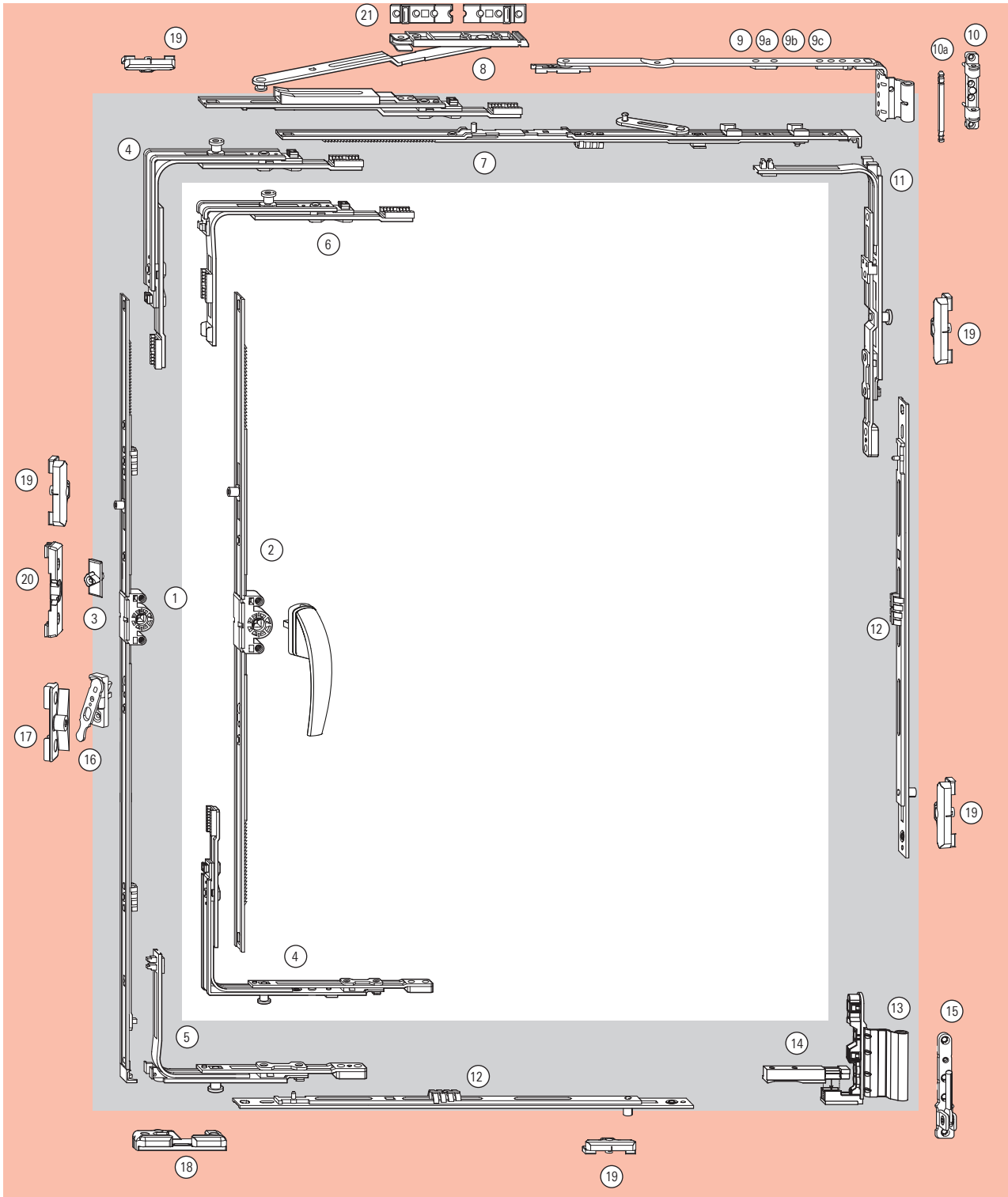

On SRH < 500 mm, the tilt-range must be limited to 80 mm!

- ⁽¹⁾ Use an additional scissor stay from SRW 1400 mm ⁽³⁾
- ⁽²⁾ Not possible in combination with a lifting mishandling device.
- ⁽³⁾ With special corner drive ⁽³⁾
- ⁽⁴⁾ With corner drive ⁽⁴⁾
- ⁽⁵⁾ On SRW < 310 mm assembly clip must be removed
- ⁽⁶⁾ Maximum tilt-range 80 mm